



Adhesives & Sealants

ANCHOR ADHESIVE PS2

Technical Data Sheet

Reviewed: 20.06.2024

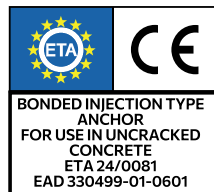

DESCRIPTION

ANCHOR ADHESIVE PS2 is a 2-component rapid-curing polyester-based chemical anchoring system for medium to high loads in masonry and concrete. It is solvent and styrene-free (VOC < 1g/Lt), has a very light odor (suitable for indoor and outdoor use), and exhibits zero shrinkage. It can be applied in dry and wet conditions, even in flooded holes.

ADVANTAGES

- Rapid curing
- Expected service life > **100 years**
- Almost zero volatile organic compounds (VOC < 1g/Lt)
- Meets **LEED v4.1** specifications
- Approved for applications in concrete even in wet conditions (**ETAG 001** Parts 1 & 5 Option 7)
- Approved for applications in masonry (**ETAG 029**)
- Suitable for applications in solid and perforated bricks
- High load-bearing capacity
- Applied with a standard hand gun
- Does not slip, even in roof applications
- Creates watertight anchorings - welds

APPLICATIONS

Anchoring - fixing with:

- Rods / reinforcements
- Anchor screws with thread (nuts)
- Screws and special fixing systems

Suitable substrates:

- Concrete
- Masonry with solid and perforated bricks
- Natural and artificial stones of high hardness
- Solid rocks or stones
- Voided stone or rock

Ideal for installations in: Canopies, ventilation systems, railings, handrails, masonry supports, signs, safety barriers, balcony fences, racking, machinery etc.

It is advisable to carry out a suitability test prior to any application in terms of the desired bonding strength, and for the prevention of surface staining due to the wide variety of possible substrates, in terms of strength, composition and porosity.

INSTRUCTIONS FOR USE

Hollow Substrate Installation Method (Figure 1)

1. Drill the hole to the correct diameter and depth. This should be done with a rotary percussion drilling machine to reduce spalling.
2. Thoroughly clean the hole in the following sequence using a brush with the required extensions and a source of clean compressed air. For holes of 400mm or less deep, a blow pump may be used: Brush Clean x1. Blow Clean x1.
3. Select the appropriate static mixer nozzle for the installation, open the cartridge/foil pack and screw nozzle onto the mouth of the cartridge. Insert the cartridge into a good quality applicator.
4. Extrude the first part of the cartridge to waste until an even colour has been achieved without streaking in the resin.
5. Select the appropriate perforated sleeve and insert into the hole.



Adhesives & Sealants

ANCHOR ADHESIVE PS2

Technical Data Sheet

Reviewed: 20.06.2024

6. Insert the mixer nozzle to the bottom of the perforated sleeve, withdraw 2-3mm then begin to extrude the resin and slowly withdraw the mixer nozzle from the hole ensuring that there are no air voids as the mixer nozzle is withdrawn. Fill the perforated sleeve and withdraw the nozzle completely.
7. Insert the clean threaded bar, free from oil or other release agents to the bottom of the hole using a back-and-forth twisting motion ensuring all the threads are thoroughly coated. Adjust to the correct position within the stated working time.
8. Any excess resin will be expelled from the hole evenly around the steel element showing that the hole is full. This excess resin should be removed from around the mouth of the hole before it sets.
9. Leave the anchor to cure. Do not disturb the anchor until the appropriate loading time, has elapsed depending on the substrate conditions and ambient temperature.
10. Attach the fixture and tighten the nut to the recommended torque. Do not overtighten.

Solid Substrate Installation Method (Figure 2)

1. Drill the hole to the correct diameter and depth. This can be done with either a rotary percussion or rotary hammer drilling machine depending upon the substrate.
2. Thoroughly clean the hole in the following sequence using a brush with the required extensions and a source of clean compressed air. For holes of 400mm or less deep, a blow pump may be used: Blow Clean x2 → Brush Clean x2 → Blow Clean x2 → Brush Clean x2 → Blow Clean x2. If the hole collects water, the current best practice is to remove standing water before cleaning the hole and injecting the resin. Ideally, the resin should be injected into a properly cleaned dry hole.
3. Select the appropriate static mixer nozzle for the installation, open the cartridge/foil pack and screw nozzle onto the mouth of the cartridge. Insert the cartridge into a good quality applicator.
4. Extrude the first part of the cartridge to waste until an even colour has been achieved without streaking in the resin.
5. If necessary, cut the extension tube to the depth of the hole and push onto the end of the mixer nozzle. Attach extension tubing and resin stopper.
6. Insert the mixer nozzle (resin stopper / extension tube if applicable) to the bottom of the hole. Begin to extrude the resin and slowly withdraw the mixer nozzle from the hole ensuring that there are no air voids as the mixer nozzle is withdrawn. Fill the hole to approximately ½ to ¾ full and withdraw the nozzle completely.
7. Insert the clean threaded bar, free from oil or other release agents to the bottom of the hole using a back-and-forth twisting motion ensuring all the threads are thoroughly coated. Adjust to the correct position within the stated working time.
8. Any excess resin will be expelled from the hole evenly around the steel element showing that the hole is full. This excess resin should be removed from around the mouth of the hole before it sets.
9. Leave the anchor to cure. Do not disturb the anchor until the appropriate loading time, has elapsed depending on the substrate conditions and ambient temperature.
10. Attach the fixture and tighten the nut to the recommended torque. Do not overtighten.

Caution: The anchor must be placed within the working time (consult table). During the hardening time the anchor must not be moved or loaded.

For applications in hollow bricks, aerated concrete blocks and stones an internal threaded socket must be used.

When the work is interrupted the static mixer can remain on the cartridge after the gun pressure has been relieved. If the resin has hardened in the nozzle a new nozzle must be attached.
Do not use after expiry date.

CLEANING

Wash hands and skin thoroughly with warm soap water. Clean residues while still wet with nitro solvent. Cured material can only be removed with mechanical means.

TECHNICAL CHARACTERISTICS

Base: Styrene – Free Polyester resin

Color: Part A: white, Part B: gray, end-product A+B: light gray

Consistency: Paste

Density: 1,65 ± 0,05 kg/Lt (A+B)

Open time: Consult table below

Shrinkage - Expansion: None

Slip: Negligible

Application temperature: Consult table below

Final adhesion: 35min – 145min Consult table below

Compressive Strength: 70 N/mm², BS6319

Tensile Strength: 12,0 N/mm², ASTM D 638 @ +20°C

Elongation at break: 0,1%, ASTM D 638 @ +20°C

Tensile Modulus: 4,5 GN/mm², ASTM D 638 @ +20°C

Flexural Strength: 28,5 N/mm², ASTM D 790 @ +20°C

Temperature Resistance: -40°C to +80°C (max long-term temperature +50°C, max short-term temperature +80°C)

STORAGE

In a cool and dry place at temperatures between +5°C - +25°C

SHELF LIFE

18 months in unopened packaging in the above-mentioned storage conditions

PACKAGING

Cartridges 300ml

PACKAGING	CODE	BARCODE
300ml	04226	5204094042266

Evochem[®]

EVOCHEM S.A.

Tzavardella place 13341, Fyli, Attica, Greece

Tel.: 210 5590460, 210 5590155 Fax: 210 5590244

E-mail: info@evochem.gr Website: www.evochem.gr



Figure 1

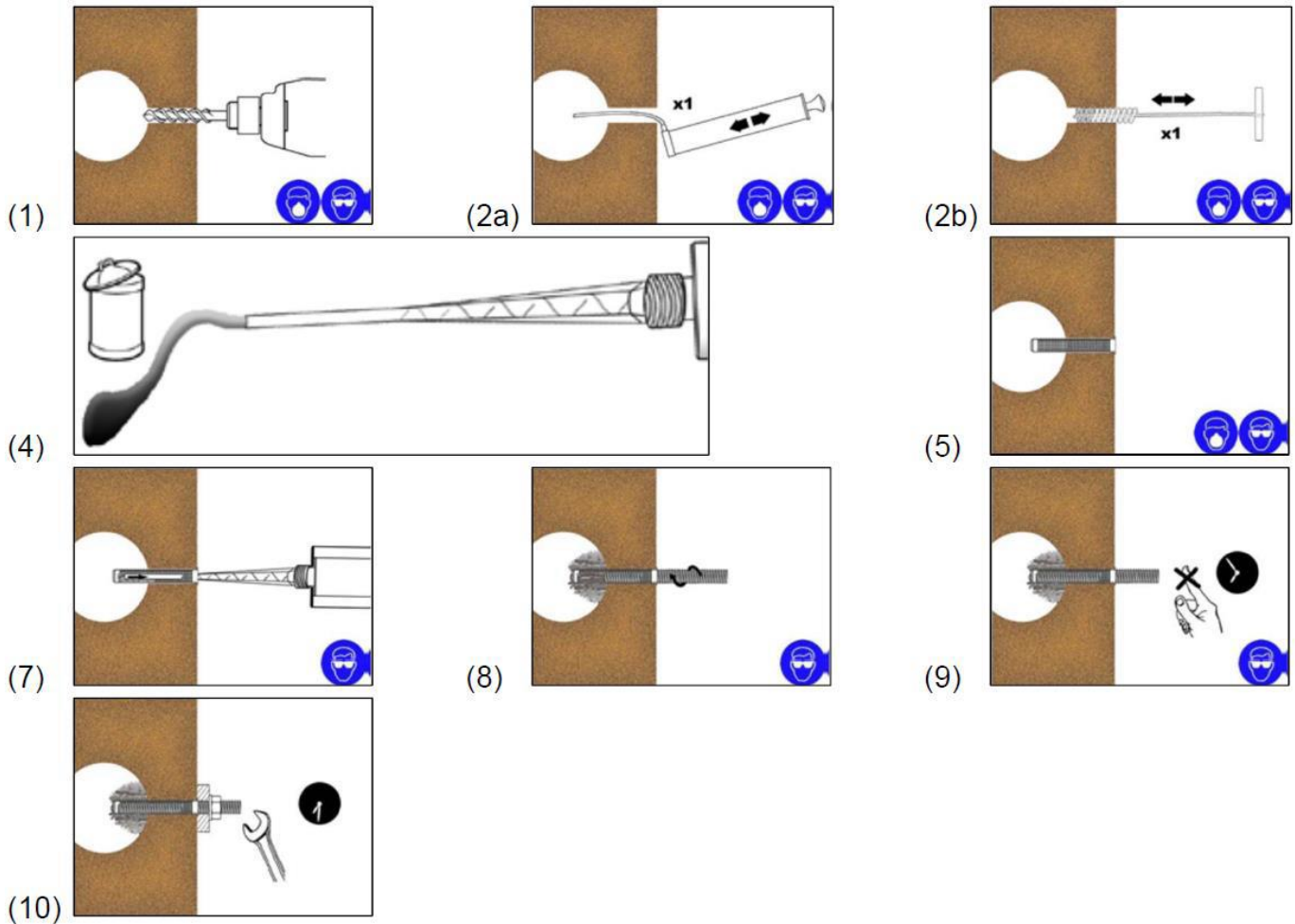
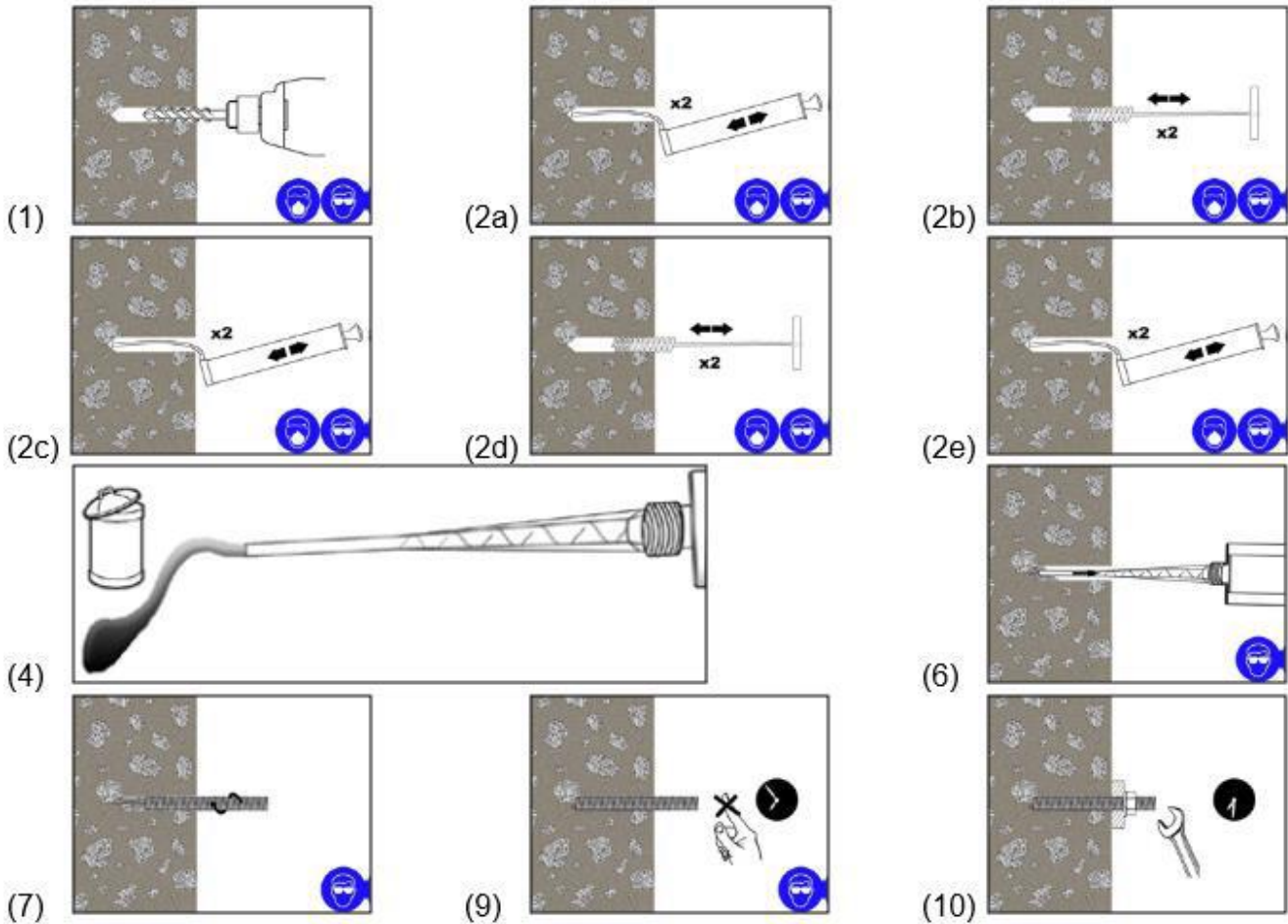

Figure 2





Adhesives & Sealants

ANCHOR ADHESIVE PS2

Technical Data Sheet

Reviewed: 20.06.2024

Working Time & Drying Time

Resin cartridge temperature	T Work (mins)	Base material Temperature	T Load (mins)
+5°C	18	+5°C	145
+5°C to +10°C	10	+5°C to +10°C	145
+10°C to +20°C	6	+10°C to +20°C	85
+20°C to +25°C	5	+20°C to +25°C	50
+25°C to +30°C	4	+25°C to +30°C	40
+30°C	4	+30°C	35

* Adhesive & substrate temperature may vary, affecting workability and drying times.

Installation Parameters - Threaded Rods

Anchor's Size	M8	M10	M12	M16	M20	M24
Nominal Drill Hole Diameter (Do) mm	10	12	14	16	22	26
Diameter of Cleaning Brush (Db) mm	14	14	20	20	29	29
Torque Moment (Tinst) Nm	10	20	40	80	150	200
Minimum Embedment Depth (Hef) mm	64	80	96	128	160	192
Maximum Embedment Depth (Hef) mm	96	120	144	192	240	288
Minimum Edge Distance (Cmin) mm	35	40	50	65	80	95
Minimum Spacing (Smin) mm	35	40	50	65	80	95
Minimum Member Thickness (Hmin) mm	Hef + 30 mm ≥ 100mm			Hef + 2Do		

HEALTH AND SAFETY INFORMATION

Consult recent Safety Data Sheet before use.

Component A

Component B

UFI: T5W0-80Q6-Q006-TMGN



The directives contained in this technical data sheet are the result of our long experience from real life applications and the research testing of our research and development laboratory and have been submitted in good faith. Because of the diversity of the materials and substrates and the great number of possible applications, which are beyond our control, we cannot accept any responsibility for the results obtained. In every case it is recommended to carry out preliminary experiments. We are liable only for our products for being free from faults and of consistent quality. Users are responsible for complying with local legislation and for obtaining any required approvals or authorizations. The present edition of this technical datasheet automatically cancels any previous ones concerning the same product.



Evochem®

EVOCHEM S.A.
Tzavardella place 13341, Fyli, Attica, Greece
Tel.: 210 5590460, 210 5590155 Fax: 210 5590244
E-mail: info@evochem.gr Website: www.evochem.gr

